



RAST5 CONNECTIONS

HVAC & WHITE GOODS APPLIANCES



CTR14

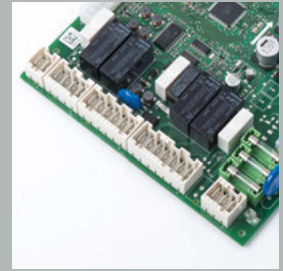

CTR1



FRIDGE



ELECTRIC
IRON

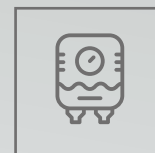

BOILER



HEATER



MICROWAVE



DISHWASHER



WASHING
MACHINE



OVEN

CTR1P5_2 -12Vxx

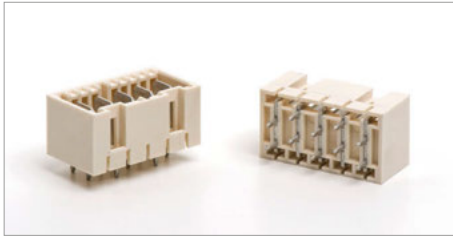

CTR1P5_2 -12Vxx

VERSION: ...

Vertical

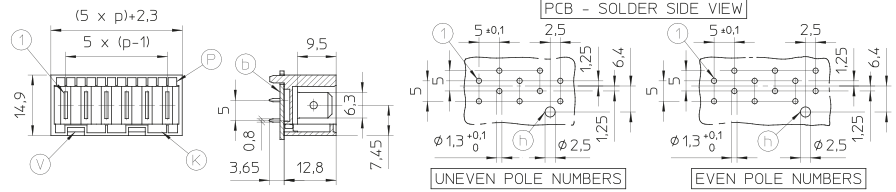

CTR1P5_2 -12SQVxx

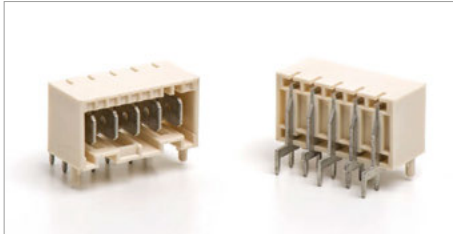

CTR1P5_2 -12SQVxx

VERSION: SQ

90 Degrees

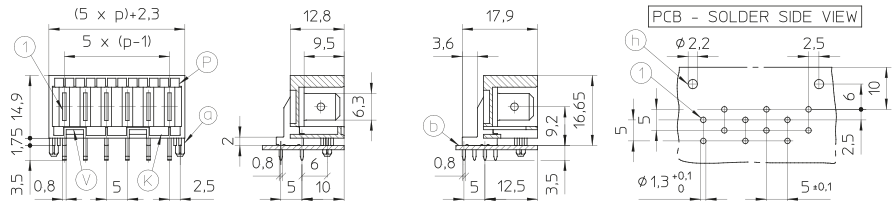

CTR1P5_2 -12SQWPVxx

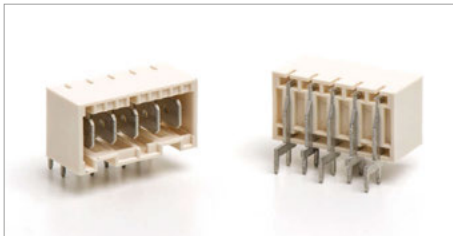

CTR1P5_2 -12SQWPVxx

VERSION: SQ WP

90 Degrees w/o peg

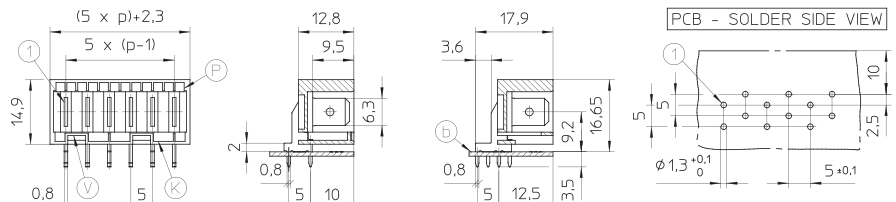

CTR1P5_2 -12SQLVxx

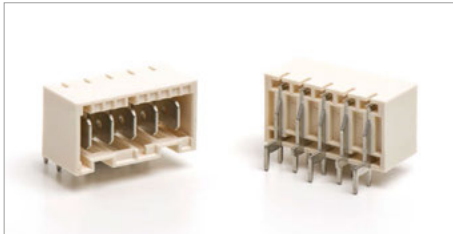

CTR1P5_2 -12SQLVxx

VERSION: SQL

90 Degrees low

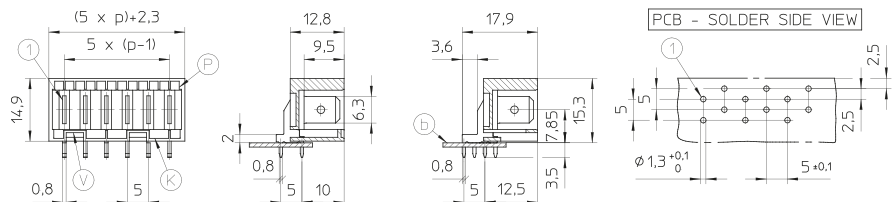

CTR1P5_2 -12SQLRVxx

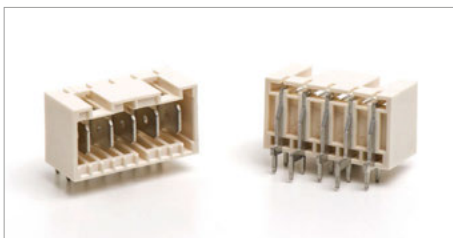

CTR1P5_2 -12SQLRVxx

VERSION: SQLR

90 Degrees low reverse

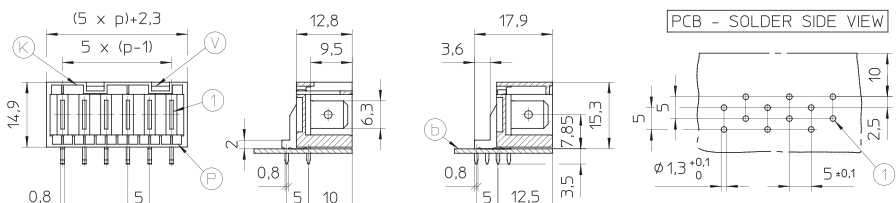

1: first contact / a: spigot / b: PCB / h: hole for positioning of the spigot
Keying V: space for locking / P: positioning / K: keying

How to order

CTR1	P5	/ XX	x..	Vxxx	Y
Type	Pitch	Poles	Version	Keying	Colours

Colours

NA / on demand GR GR1 NE AR BL RO GI VE BI

Technical Data

Materials

Housing: PA G - UL94 V0 _ GWT 750 °C
compliant to Norm EN60335-1

Contact tabs: 6,3 x 0,8 mm
Copper Alloy / Ni + Sn

Electrical data

Rated current: 10 A
Rated voltage: 250 V
Impulse withstand voltage: 2,5 kV

Insulation distances: >= 4 mm

Temperature range: -40 °C ÷ +120 °C

CTR14P5_2-7Vxx



CTR14P5_2-7Vxx

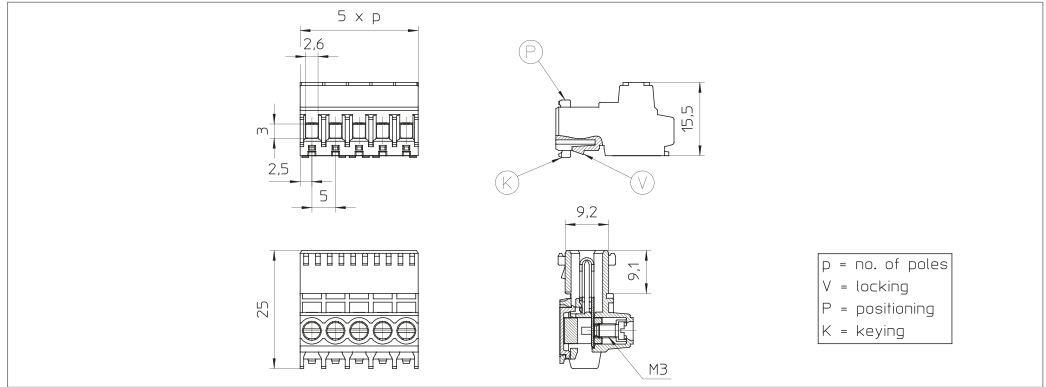

How to order

CTR14	P5	/ XX	Vxxx	Y
Type	Pitch	Poles	Keying	Colours

Colours

NA / on demand GR GR1 NE AR BL RO Gi VE BI

Technical Data

Materials
 Housing: PA G - UL94 V0_GWT 750 °C compliant to Norm EN60335-1
 Contacts: Copper Alloy / Sn
 Clamp: Copper Alloy / Ni
 Captive screw (M3): Steel / Zn

Mechanical Data
 Torque 0,5 Nm
 Solid wire: 0,2-4 mm²
 Stranded wire: 0,2-2,5 mm²
 Stripping length: 7-8 mm

Electrical data
 Rated current: 10 A
 Rated voltage: 250 V
 CTI: 400 V (Material Group II)
 Insulation distances: > = 4 mm
 Temperature range: -40 °C ÷ +120 °C

Notes VDE & UL approvals in progress

Options

CTR1 IN DIFFERENT COLOURS



CTR14 IN DIFFERENT COLOURS





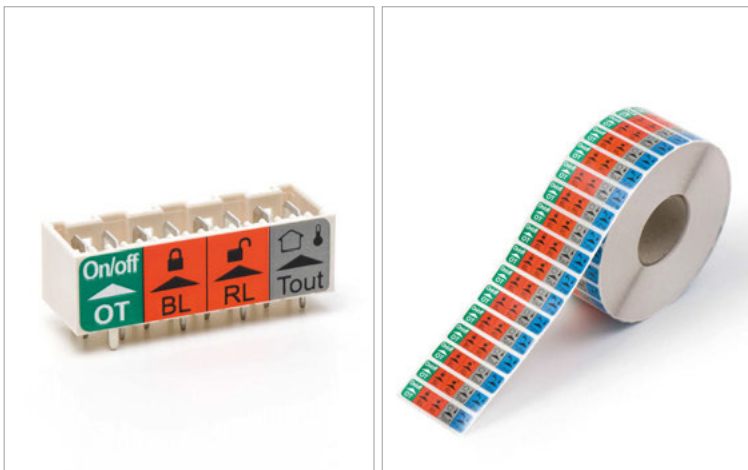











LABELS ON DEMAND







EARTH OR FIRST IN / LAST OUT CONTACT



OTHER PRODUCTS FOR HVAC & WHITE GOODS

Type	Vertical	Horizontal	Angled	Interlocking modules	Single block	Pitch (mm)	Poles	Rated Voltage (V)	Rated Current (A)	Types of cables Nominal cross section (mm ² AWG)			Body height (mm)
		SQ 											
CFM  M	•	•			•	5,08	2/8	320	4				18,8
BS95  F	•	•			•	5,08	2/8						15,5
CT84 						8,5			4	0,5 ÷ 1 20 ÷ 16	0,5 ÷ 1 20 ÷ 16	0,5 ÷ 1 20 ÷ 16	13,8
CQQ  Fast-on	•				•	5,08 7,62 10,16 12,7 15,24	2/17 2/11 2/9 2/7 2/6	200 320 500 630 630	6 10 16	1-1,5-2,5 18-16-14	1-1,5-2,5 18-16-14	1-1,5-2,5 18-16-14	11
CQS  Fast-on		•			•	5,08 7,62 10,16 12,7 15,24	2/17 2/11 2/9 2/7 2/6	200 320 500 630 630	6 10 16	1-1,5-2,5 18-16-14	1-1,5-2,5 18-16-14	1-1,5-2,5 18-16-14	21
MRT12 	•				•	5 7,5 10	2/24 2/12 2/12	250 500 630	24	0,5 ÷ 4 30 ÷ 12	0,5 ÷ 2,5 30 ÷ 12	0,5 ÷ 2,5 30 ÷ 12	11,5
CBL 	•				•	5 10	2/24 2/12	250 500	24	0,5 ÷ 4 30 ÷ 12	0,5 ÷ 2,5 30 ÷ 12	0,5 ÷ 2,5 30 ÷ 12	13
CUU 	•	•			•	5 10	2/36 2/18	250 500	22	0,2 ÷ 4 30 ÷ 12	0,2 ÷ 2,5 30 ÷ 12	0,2 ÷ 2,5 30 ÷ 12	15,5

Type	Fuse link	Mounting	Rated Voltage (VAC)	Rated Current (A)	Rated power (W)			GWT EN 60335-1	High Temperature Thermoplastic	Degree of protection	Protection class	Accessories
PTF/15 - PTF/15B 	5x20	P.C.B.	250	20 P (cURus) 6,3 (VDE)	1,6	•	•	•	D	IP00	PC1	BS140 
PTF/45 	5x20	P.C.B.	250	20 (cURus) 10 (VDE)	2,5	•	•	D		IP20	PC2	

P = Pending
D = On demand

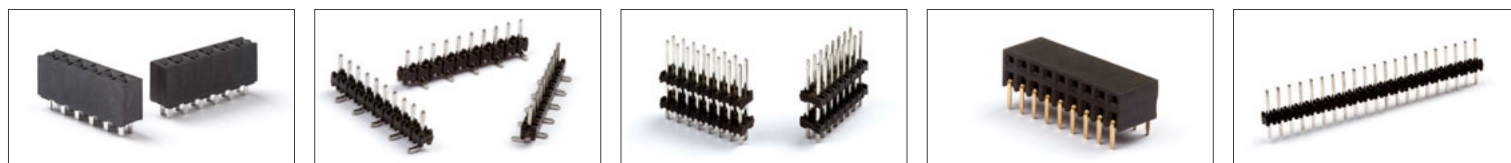

Stay Connected With Us



Würth Elektronik Stelvio Kontek S.p.A.

via al Mognago, 49
23848 Oggiono (LC) - Italy

T +39 0341 265411
info@stelvio-kontek.com

stelvio-kontek.com

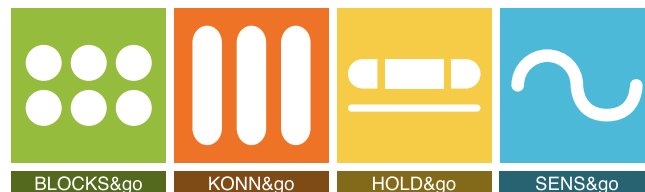

Discover the complete line of Würth Elektronik Stelvio Kontek's products.